



## Stainless Shelves Upgrade Assembly Instructions



Follow these instructions when converting bamboo side shelves to stainless steel or Platinum grade.



### Parts

#### Included Parts:

- 2 Stainless Steel Shelf Tops
- 8 M5 screws and Nuts



#### Other Required Parts (not included)

- Pair of assembled bamboo side shelves from Saffire Cart Kit (Silver Class or Bronze Class)



**Step 1.** Take one assembled bamboo side shelf. Place shelf upside down on a soft surface

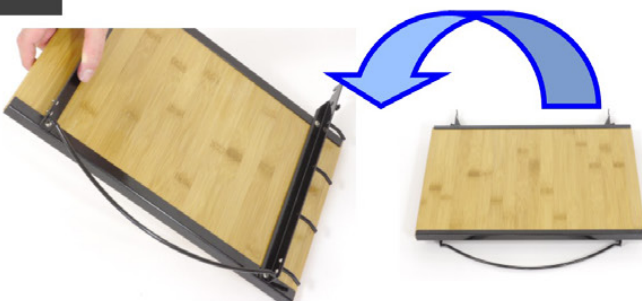

**Step 2.** Remove all 4 wood screws that connect the metal shelf frame to the bamboo.

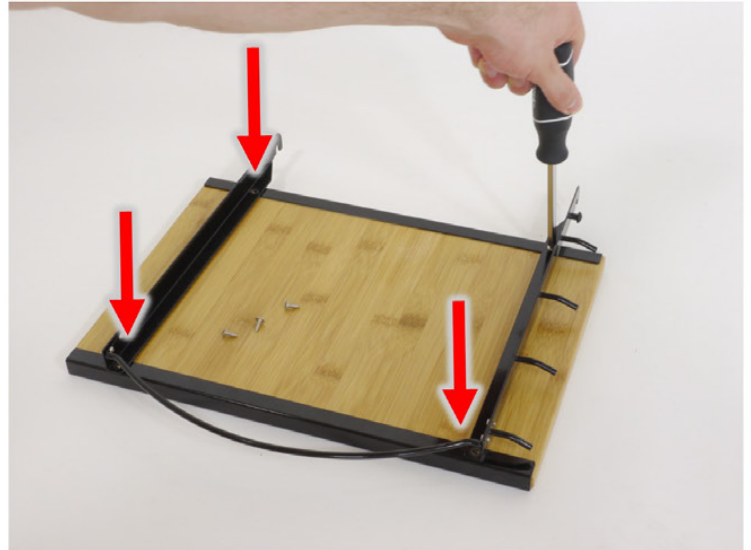

**Step 3.** Lift the metal shelf frame off of the bamboo. (The metal rims on each end of the bamboo can remain on the bamboo)



**Step 4.** Take one stainless steel side shelf top and flip it over upside down on a soft and clean surface.  
(Remove any protective factory tape)



**Step 5.** Take the metal shelf frame, that was just removed from the bamboo, and place onto the Stainless top and line up the 4 holes.

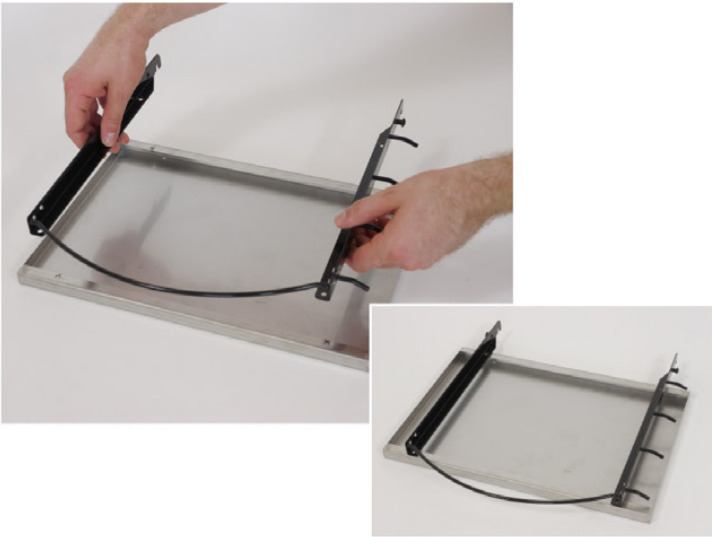

**Step 6.** Prepare to fasten the metal shelf frame to the stainless top using one M5 screw and nut for each of the 4 holes.

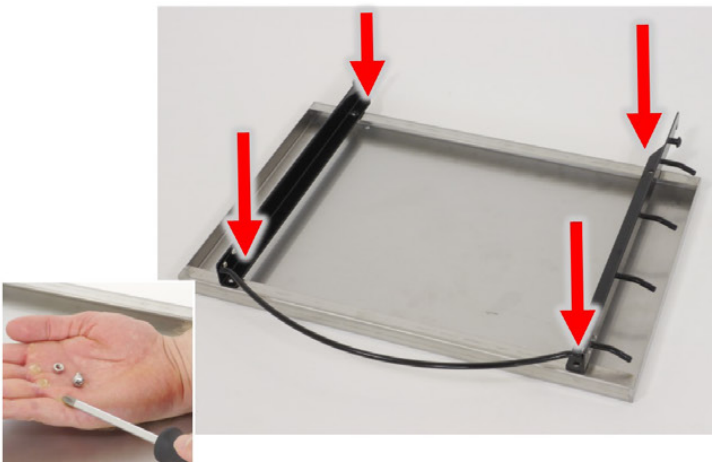

**Step 7.** Place the nut on the tip of a screw driver or hold with a pair of pliers and position the nut within the folded rim of the stainless top and underneath the hole.

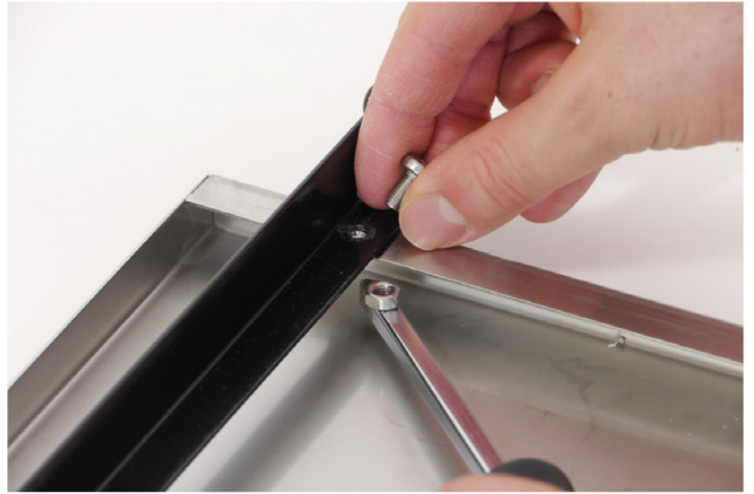

**Step 8.** Insert the screw from above but keep connection loose until all 4 screws have been started. Then tighten all 4 screws and nuts until secure. Hold the nuts with a wrench to tighten if necessary.

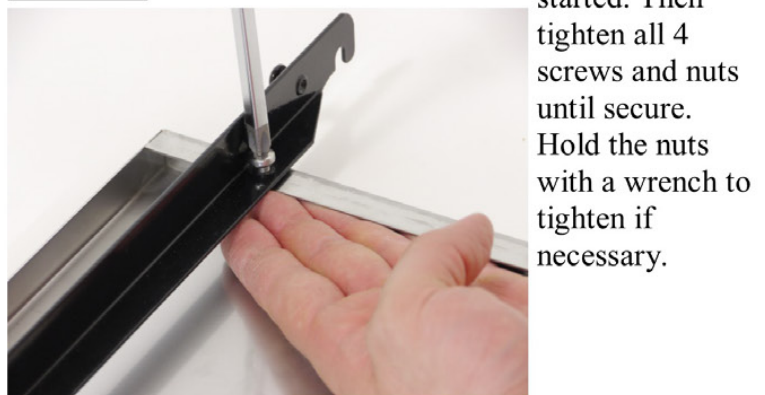

**Step 9.** The side shelf upgrade is complete. Repeat the process for the second shelf.

